



INHOUSE RIDER MAIN HALL (update September 2021)

Willemsplein 10
6811 KB Arnhem
The Netherlands
Correspondence Address:
P.O. Box 925
6800 AX Arnhem
The Netherlands
info@luxorlive.nl
Phone: +31 (0)26 3511660

Venue:

Luxor Live - Main Hall

Address:

Willemsplein 10
6811 KB Arnhem
The Netherlands
Phone: +31 26 35 11 660
Website: www.luxorlive.nl

Capacity: 700

Load in address:

Willemsplein 10
6811 KB Arnhem
The Netherlands

Load in details:

Load in at the back entrance: Loadingdock → Elevator (210 x 120 x 180 cm HxWxD) → Stage
Load in at the front entrance (trucks & trailers only): Doors (205 x 125 cm HxW) → Main Hall → Elevator → Stage

Parking: *All parking facilities are shared with the small hall.*

Available space:

Six cars (15 x 4 meters)

Parking Power:

1x 400V/32A 3 Phase (CEE form)
1x 230V/16A 1 Phase (Schuko or CEE form)

Location:

Artist-Parking is next to the Luxor Live Office and backstage entrance at the back of the building.

Hospitality:

Dinner:

Hot meal will be served in house.

Dressing rooms:

1x Large lockable dressing room
1x Small lockable dressing room

You're welcome to use the dressing rooms until 1 hour after the show unless agreed upon otherwise.

Shower:

2x Shower, Towels included.

Wi-fi:

Yes, SSID & Password provided in dressing room.

Merchandise:

Sell by yourself. Merchandise stand in the back of the hall provided on request with light & power.

Contact:

Preproduction:

Jessica van Vorstenbos
jessica@luxorlive.nl
+31-(0)26-3511660

Technical Production/Sound:

Mattijs de Vroomen
mattijs@luxorlive.nl
+31-(0)6-36568181

Technical Production/Light & Video:

Mitch van der Meijden
Mitch@luxorlive.nl

Note:

Sound limitations: 103 dB(a) peak LEQ 15 minutes. in accordance with the national VNPF/VVEM covenant. Measured with 10EaZy calibrated IEC61672-3 Class 2 equipment. The entire (dutch) covenant can be found here: <https://zoek.officielebekendmakingen.nl/stcrt-2016-36467.html>

Safety: Luxor Live attempts to create a working environment that is as safe as possible. We kindly ask visiting technicians to consider the safety of themselves, our employees, the artists and the audience when working in our venue. Luxor Live reserves the right to cancel or refuse certain parts of the show that, in our opinion, have safety issues. In light of this also think about wearing safety-shoes on load-in or outs.

If you have any doubts about this in regards to your show please contact us in advance so we can discuss the matter.

Decoration flammability: regarding the flammability of decorations we follow the rules as described in the NBR2011:01 "Brandveiligheid van decors, doeken en decoratiemateriaal". This (dutch) document can be found here: <http://docplayer.nl/15037675-Brandveiligheid-van-decors-doeken-en-decoratiemateriaal.html> and is also available through us on request. If an English explanation is required, please contact us for this documents highlights.

This or any other document in no way alters the right described in the previous section to cancel or refuse certain parts of the show if they have safety issues of any kind. Luxor Live always has the final say in safety disputes.

Technical specifications: www.luxorlive.nl/tech-specs

Stage dimensions: See page 3.

There will be at least two sound technicians, one lighting technician and one backstage host present. The time schedule will be sent at least 2 weeks prior to show date.

* CHANGES IN GET IN TIMES AND AMOUNT OF LOCAL CREW, LESS THAN ONE WEEK PRIOR TO SHOW DATE, CANNOT BE ACCEPTED DUE TO PERSONNEL PLANNING. *

THEATRE

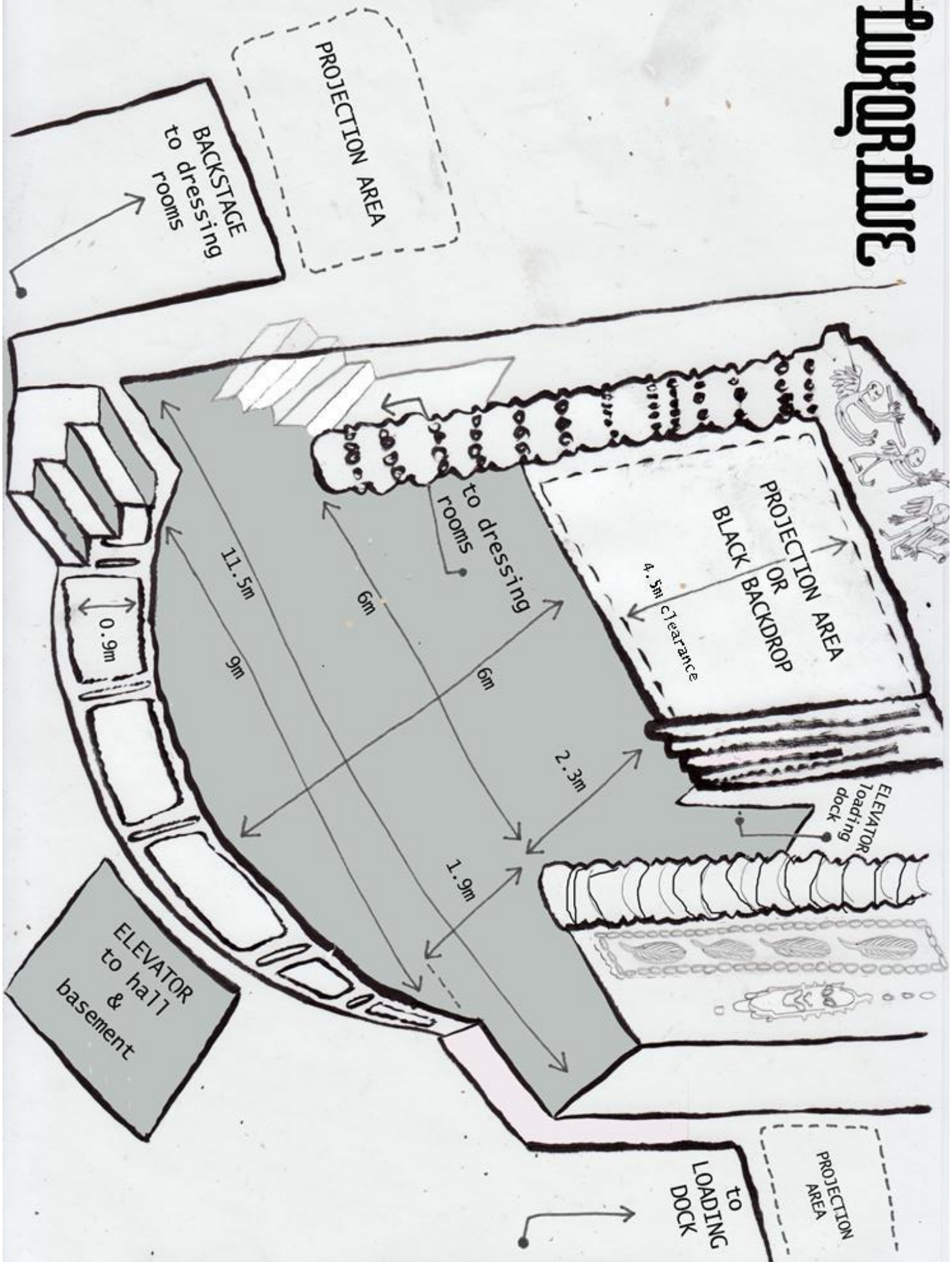

Directions:

Google maps address: Willemsplein 10, 6811KB, Arnhem, Netherlands.

Google maps link: <https://goo.gl/maps/oL3SgHL7Stq>

GPS Coordinates: Latitude: 51.983666 | Longitude: 5.904498



Environmental protection zone:

Please note, our venue lies within the environmental protection zone of the Arnhem city center. This means that it is not permitted to travel into the city with diesel vehicles that have a Euronorm lower than 4 (IV). This is enforced by the municipality with digital cameras on entry roads and will result in a €100 - €250 fine. It is possible to request exemption beforehand. If you travel with vehicles that require this exemption contact us well in advance so we can help with the request for exemption with the Arnhem municipality.

Arnhem municipality information on environmental zone (in Dutch):

<https://www.arnhem.nl/stad-en-wijken/Wegen-en-vervoer/milieuzone>

Nationwide information on environmental zones (in English):

<https://www.milieuzones.nl/english>

Nationwide information on environmental zones & NL license plate checker (in Dutch):

<https://www.milieuzones.nl/>

From Utrecht:

1. Follow, A12 direction: East, Arnhem 53,8 km
2. Take Exit 25: 'Oosterbeek' follow N224 direction: 'Arnhem-Centrum/Wolfheze' 5,9 km
3. Follow 'Amsterdamseweg' 2,7 km
4. Take a right turn at 'Willemsplein' 0,2 km
5. Keep right at 'Willemsplein', direction Central Trainstation (Don't enter the Tunnel!).
6. Take the first turn on your right, before the traffic lights & tunnel, towards 'oude stationsstraat'. Proceed towards the roadblock and ring our doorbell.

From Nijmegen:

1. Follow N325, direction: North 6,1 km
2. Follow A325 6,7 km
3. Follow 'Nijmeegseweg-Oost' 0,8 km
4. Go Straight Ahead at, 'De Monchysplein' 85 m
5. Follow 'Nijmeegseweg-Oost' 0,3 km
6. Go straight ahead on the Roundabout.
7. Follow 'Velperbuitensingel' 0,4 km
8. Follow 'Jansbuitensingel' 0,4 km
9. Take a slight left turn at 'Willemsplein' 0,1 km
10. Keep right at 'Willemsplein', direction Central Trainstation (Don't enter the Tunnel!).
11. Take the first turn on your right, before the traffic lights & tunnel, towards 'oude stationsstraat'. Proceed towards the roadblock and ring our doorbell.

From Doetinchem:

1. Follow A18, Direction: West
2. Follow A12, Direction: 'Arnhem'
3. Take exit 26: 'Arnhem Noord'
4. Follow 'Apeldoornseweg' N784, 1 km
5. Take a right at 'Sonsbeekweg' 0,4 km
6. Take a left at 'Zijpendaalseweg' 60 m
7. Follow 'Willemsplein' 0,2 km
8. Keep right at 'Willemsplein', direction Central Trainstation (Don't enter the Tunnel!).
9. Take the first turn on your right, before the traffic lights & tunnel, towards 'oude stationsstraat'. Proceed towards the roadblock and ring our doorbell.

From Germany:

1. Follow A3, E35
2. Cross Border, Follow A12, Direction: 'Arnhem' 20,9 km
3. Take exit 26: 'Arnhem Noord'
4. Follow 'Apeldoornseweg' N784, 1 km
5. Take a right at 'Sonsbeekweg' 0,4 km
6. Take a left at 'Zijpendaalseweg' 60 m
7. Follow 'Willemsplein' 0,2 km
8. Keep right at 'Willemsplein', direction Central Trainstation (Don't enter the Tunnel!).
9. Take the first turn on your right, before the traffic lights & tunnel, towards 'oude stationsstraat'. Proceed towards the roadblock and ring our doorbell.