



LUXOR LIVE

LUXOR LIVE

ROUTE INFORMATION



DIRECTIONS & TRANSPORT

VENUE

INFO

NAME

LUXOR LIVE

VISITOR ADDRESS

WILLEMSPLEIN 10
6811 KB ARNHEM
THE NETHERLANDS

LOAD IN

LOAD IN ADDRESS

WILLEMSPLEIN 10
6811 KB ARNHEM
THE NETHERLANDS

MAIN HALL & BASEMENT – LOAD IN DETAILS

LOAD IN AT THE BACK ENTRANCE:

PASSENGER CARS AND VANS
LOADINGDOCK → ELEVATOR (210 × 120 × 180 CM H×W×D) → STAGE

LOAD IN AT THE RIGHT FRONT ENTRANCE:

BOX TRUCKS AND BIGGER
DOORS (205 × 125 CM H×W) → MAIN HALL → ELEVATOR → STAGE

SMALL HALL – LOAD IN DETAILS

LOAD IN AT THE LEFT FRONT ENTRANCE:

ELEVATOR (210 × 90 × 130 CM H×W×D) TO 2ND FLOOR →
DOOR (210 × 85 CM H×W×D) TO SMALL HALL

PARKING

ALL PARKING FACILITIES ARE SHARED BETWEEN HALLS.

AVAILABLE SPACE

≈ SIX CARS (≈16 × 5 METERS)*

* NIGHTLINERS ARE USUALLY PARKED OUTSIDE OF OUR PARKING IN FRONT OF OUR OFFICE WITH AN EXEMPTION TO THE MUNICIPAL NO-PARKING ZONE PROVIDED BY US.

PARKING POWER

1 × 400V/32A 3 PHASE (CEE FORM)
1 × 230V/16A 1 PHASE (SCHUKO OR CEE FORM)

SECURITY

THE ARTIST PARKING IS ENCLOSED BEHIND A GARAGE DOOR FOR WHICH THE ACCESS CODE CAN BE PROVIDED ON THE DAY OF THE SHOW.

LOCATION

ARTIST-PARKING IS NEXT TO THE LUXOR LIVE OFFICE AND BACKSTAGE ENTRANCE AT THE BACK OF THE BUILDING.

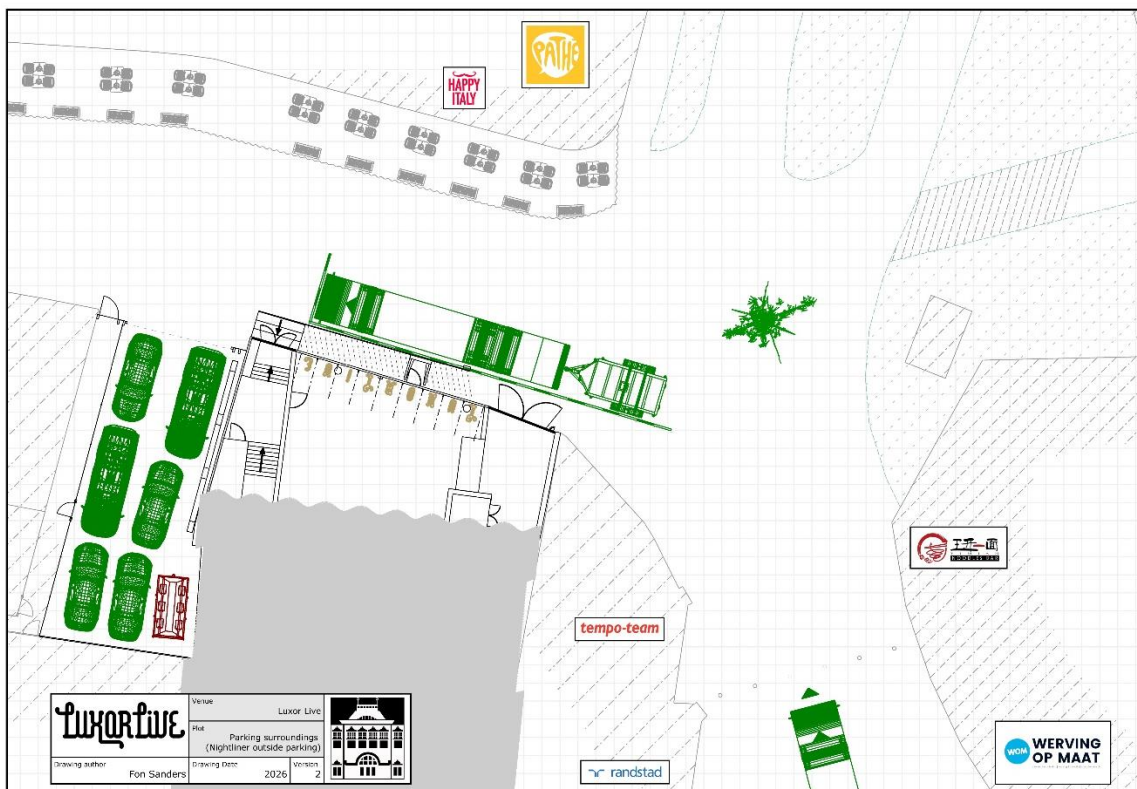

RULES & REGULATIONS

ENVIRONMENTAL PROTECTION & ZERO EMISSION ZONE

PLEASE NOTE, OUR VENUE LIES WITHIN THE ENVIRONMENTAL PROTECTION & ZERO EMISSION ZONE OF THE ARNHEM CITY CENTER. THIS MEANS THAT FROM 01-06-2026 ONWARD ACCESS TO THE CITY CENTER IS LIMITED FOR CERTAIN VEHICLES.

THIS IS ENFORCED WITH DIGITAL CAMERAS ON ENTRY ROADS AND NON-COMPLIANCE WILL RESULT IN A €130 - €320 FINE.

IT IS POSSIBLE TO PURCHASE EXEMPTIONS BEFOREHAND.

IF YOU ARE UNSURE WHETHER YOUR VEHICLE IS ALLOWED OR IN WHICH CATEGORY IT FALLS, PLEASE USE BOTH THE LICENSE PLATE CHECKERS BELOW (FOR DUTCH LICENSE PLATES ONLY).

IF YOU TRAVEL WITH VEHICLES THAT (MIGHT) REQUIRE THIS EXEMPTION AND NEED HELP PLEASE CONTACT US WELL IN ADVANCE.

ARNHEM MUNICIPALITY INFORMATION ON ENVIRONMENTAL PROTECTION & ZERO EMISSION ZONE (IN DUTCH):

[ARNHEM.NL/ALLE-ONDERWERPEN/VERKEER/MILIEUZONE-EN-ZERO-EMISSIEZONE](https://www.arnhem.nl/alle-onderwerpen/verkeer/milieuzone-en-zero-emissiezone)

ZERO EMISSION ZONE (CARGO VEHICLES, VEHICLE CATEGORIES N1, N2 & N3):

FOR CARGO VEHICLES LIKE VANS (N1) & TRUCKS (N2/N3) ACCESS IS LIMITED TO ZERO-EMISSION VEHICLES.

EXEMPTIONS CAN BE PURCHASED THROUGH THE RDW

PURCHASE EXEMPTION TO THE ZERO EMISSION ZONE (CARGO VEHICLES) AT THE RDW (IN DUTCH):

[RDW.NL/ONTHEFFING-ZERO-EMISSIE/AANVRAGEN](https://www.rdw.nl/onthefing-zero-emissie/aanvragen)

NATIONWIDE INFORMATION ON ZERO EMISSION ZONES & NL LICENSE PLATE CHECKER (IN DUTCH):

[OPWEGNAARZES.NL](https://www.opwegnaarzes.nl)

ENVIRONMENTAL ZONE (DIESEL PASSENGER VEHICLES, VEHICLE CATEGORIES M1, M2 & M3):

FOR DIESEL PASSENGER VEHICLES ACCESS IS LIMITED TO VEHICLES OF A CERTAIN EURONORM OR HIGHER.

FOR CARS & PASSENGER VANS (M1) THIS IS EURONORM 5 (V) OR HIGHER AND FOR AUTOBUSES & COACHES (M2/M3)

THIS IS EURONORM 6 (VI) OR HIGHER.

EXEMPTIONS CAN BE PURCHASED THROUGH THE ARNHEM MUNICIPALITY.

PURCHASE EXEMPTION TO THE ENVIRONMENTAL PROTECTION ZONE (PASSENGER VEHICLES) AT THE ARNHEM MUNICIPALITY (IN DUTCH):

[ARNHEM.NL/PRODUCT/ONTHEFFING-MILIEUZONE-PERSONENAUTOS-EN-AUTOBUSSEN](https://www.arnhem.nl/product/onthefing-milieuzone-personenautos-en-autobussen)

NATIONWIDE INFORMATION ON ENVIRONMENTAL ZONES & NL LICENSE PLATE CHECKER (IN DUTCH):

[MILIEUZONES.NL](https://www.milieuzones.nl)

DIRECTIONS

NAVIGATION ADDRESS:

WILLEMSPLEIN 10, 6811KB, ARNHEM, NETHERLANDS.

MAP LINKS:

GOOGLE MAPS: [HTTPS://MAPS.APP.GOO.GL/ATPK3FTFAERDPKG76](https://maps.app.goo.gl/ATPk3FTFAERDPKG76)

APPLE MAPS: [HTTP://MAPS.APPLE.COM/?DADDR=WILLEMSPLEIN%2010%20ARNHEM](http://maps.apple.com/?daddr=WILLEMSPLEIN%2010%20ARNHEM)

GPS COORDINATES:

LATITUDE: 51.983666

LONGITUDE: 5.904498

MAP:

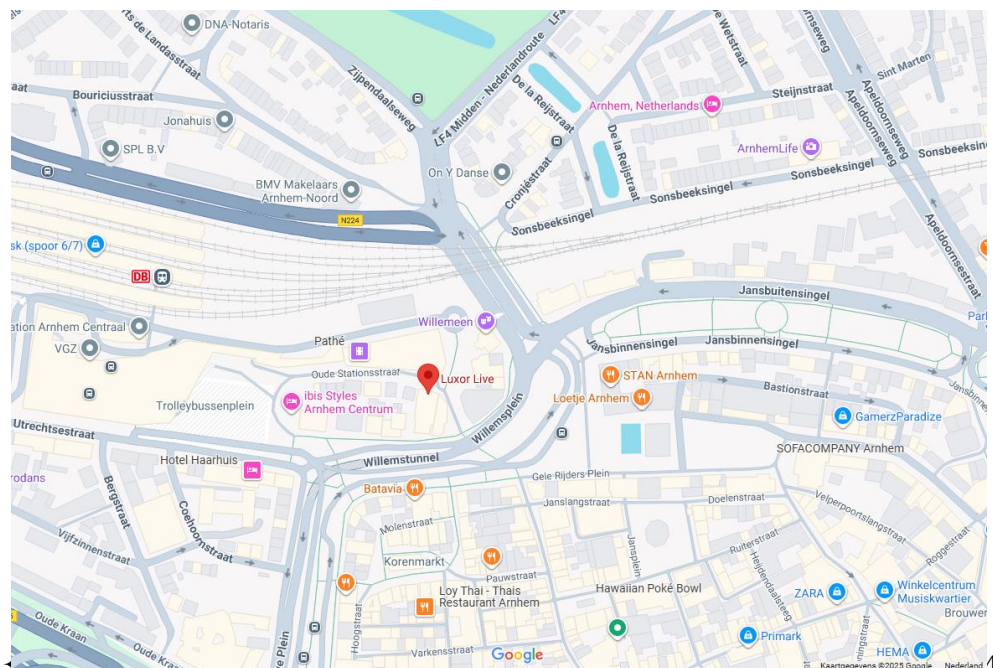

DIRECTIONS

FROM UTRECHT:

1. FOLLOW **A12** IN THE EAST DIRECTION TOWARDS **ARNHEM** FOR 53,8 KM
2. TAKE EXIT 25: **OOSTERBEEK** AND FOLLOW **N224** TOWARDS: **ARNHEM-CENTRUM/WOLFHEZE** FOR 5,9 KM
3. CONTINUE ON **AMSTERDAMSEWEG** FOR 2,7 KM
4. ON **WILLEMSPLEIN**, TAKE A RIGHT TURN AT THE 1ST TRAFFIC LIGHTS TOWARDS **P CENTRAAL**
5. KEEP RIGHT AGAIN AT THE 2ND & 3RD TRAFFIC LIGHTS ON **WILLEMSPLEIN** - (DON'T ENTER THE TUNNEL!)
 - TRUCKS SHOULD TURN RIGHT ON THE SHOULDER OVER THE FLEX-DIVIDERS JUST BEFORE THE 3RD TRAFFIC LIGHTS.
6. FROM THE LANE TOWARDS DIRECTION **STATION** IMMEDIATELY TAKE AN EVEN FURTHER RIGHT TURN TOWARDS THE PEDESTRIAN AREA AT **OUDE STATIONSSTRAAT**. PROCEED TOWARDS THE ROADBLOCK AND RING OUR DOORBELL.

FROM NIJMEGEN:

1. FOLLOW **N325** IN THE NORTH DIRECTION TOWARDS **ARNHEM** FOR 6,1 KM
2. CONTINUE ON **A325** FOR 6,7 KM
3. CONTINUE ON **NIJMEEGSEWEG-OOST** FOR 800 M
4. GO STRAIGHT AHEAD AT **DE MONCHYPLEIN**
5. FOLLOW **NIJMEEGSEWEG-OOST** FOR 300 M
6. GO STRAIGHT AHEAD ON THE ROUNDABOUT (2ND EXIT **CENTRUMRING + P**).
7. FOLLOW **VELPERBUITENSINGEL** FOR 400 M
8. CONTINUE ON **JANSBUITENSINGEL** FOR 400 M
9. AT **WILLEMSPLEIN** FOLLOW THE LANE CURVING LEFT TOWARDS **STATION** THROUGH THE 1ST AND 2ND TRAFFIC LIGHTS.
7. KEEP RIGHT AT THE 3RD TRAFFIC LIGHTS ON **WILLEMSPLEIN** - (DON'T ENTER THE TUNNEL!)
 - TRUCKS SHOULD TURN RIGHT ON THE SHOULDER OVER THE FLEX-DIVIDERS JUST BEFORE THE 3RD TRAFFIC LIGHTS.
10. FROM THE LANE TOWARDS DIRECTION **STATION** IMMEDIATELY TAKE AN EVEN FURTHER RIGHT TURN TOWARDS THE PEDESTRIAN AREA AT **OUDE STATIONSSTRAAT**. PROCEED TOWARDS THE ROADBLOCK AND RING OUR DOORBELL.

FROM DOETINCHEM OR GERMANY:

1. FOLLOW **A18** FROM DOETINCHEM OR **A3** FROM GERMANY TOWARDS **ARNHEM**
2. CONTINUE ON **A12** IN THE WEST DIRECTION TOWARDS **ARNHEM** FOR 18 KM
3. TAKE EXIT 26: **ARNHEM NOORD**
4. FOLLOW **APELDOORNSEWEG/N784** FOR 3,6 KM
5. TAKE A SLIGHT RIGHT TOWARDS **SONSBEEKWEG**
6. FROM THE RIGHT LANE TURN LEFT AT **ZIJPENDAALSEWEG**
7. CONTINUE ON **WILLEMSPLEIN** THROUGH THE 1ST TRAFFIC LIGHTS TOWARDS **P CENTRAAL**
8. KEEP RIGHT AGAIN AT THE 2ND & 3RD TRAFFIC LIGHTS ON **WILLEMSPLEIN** - (DON'T ENTER THE TUNNEL!)
 - TRUCKS SHOULD TURN RIGHT ON THE SHOULDER OVER THE FLEX-DIVIDERS JUST BEFORE THE 3RD TRAFFIC LIGHTS.
9. FROM THE LANE TOWARDS DIRECTION **STATION** IMMEDIATELY TAKE AN EVEN FURTHER RIGHT TURN TOWARDS THE PEDESTRIAN AREA AT **OUDE STATIONSSTRAAT**. PROCEED TOWARDS THE ROADBLOCK AND RING OUR DOORBELL.